

# Pressure Filters & Screens



**AQUA AURA**  
Leading Technologies



# ABR Filters

## Description:

The automatic self-cleaning filter with brushes for the prefiltration of surface and process water containing not-colloidals suspended solids.

- Stainless steel housing and filter cartridge
- Interchangeable screens with several filtration degrees
- Economic and robust choice for automation of filtration
- Low inlet pressure requested

Alfa Water ABR filters are automatic filters with a set of brushes mounted on a rotating shaft, driven by an electric motor.

ABR filters can support flow rates of up to 390 m<sup>3</sup>/h (1717 US gpm) with four sizes of screens up to 5500 cm<sup>2</sup>, with several screens covering the range of filtration degree between 2000 and 25 µm and with different range of inlet/outlet connections between 2" and 6".

Available 2 controllers:

- AWC Basic controller (differential pressure and/or preset time and/or manual start, IP54, 4DI, 4AI/DI, 4DO, LCD Display 1.5")
- AWC Full controller (as AWC Basic but it can be integrated into existing systems, no need monitoring, IP54, 4DI, 4AI/DI, 4PowerDO + 3DO, LCD Display 3.5")

## Images:

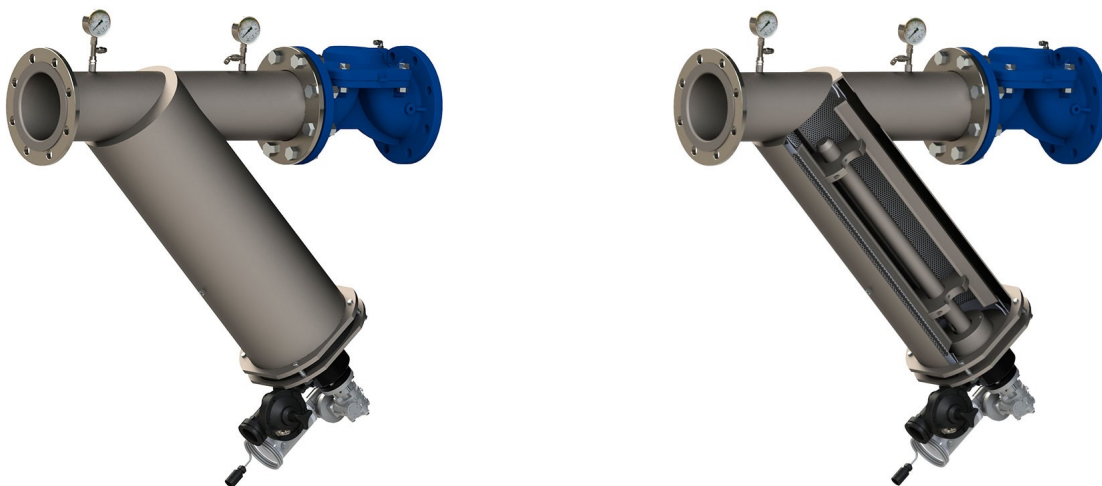

# ABR Filters

## TECHNICAL DATA - DATI TECNICI

Filter size - Taglia filtro	16	23	35	55
-----------------------------	----	----	----	----

### General data - Dati generali

Inlet/outlet diameter Diametro connessioni IN/OUT	2" / 3" / 4" flanged EN 1092-1	3" / 4" flanged EN 1092-1	4" / 6" flanged EN 1092-1	4" / 6" flanged EN 1092-1
Max flow rate Portata massima	100 m³/h 440 US gpm	180 m³/h 793 US gpm	270 m³/h 1189 US gpm	390 m³/h 1717 US gpm
Min working pressure Pressione minima	1.5 bar 22 psi			
Max working pressure Pressione massima	10 bar 145 psi			
Max working temperature Temperatura massima	60 °C 140 °F			

### Screen elements - Elementi filtranti

Screen Area Area filtrante	1600 cm² 233 in²	2300 cm² 341 in²	3500 cm² 512 in²	5500 cm² 837 in²
Filtration degree Gradi di filtrazione	2000 / 1000 / 800 / 500 / 400 / 200 / 100 / 50 / 25 µm			
Screen types Tipologia elementi filtranti	Screens: Stainless Steel AISI 316 or Multi-layers SS AISI316 + PETP (Polyester) Reti: Acciaio inox AISI 316 oppure multistrato Inox AISI316 + Poliestere PETP			

### Cleaning Cycle - Ciclo di pulizia

Cleaning cycle time Durata ciclo di pulizia	20 - 30 sec			
Min cleaning flow rate Portata minima di pulizia	5 m³/h 22 US gpm	7 m³/h 31 US gpm	7 m³/h 31 US gpm	10 m³/h 44 US gpm
Rinse water discharged (20 sec) Acqua di pulizia scaricata	30 L	40 L	40 L	60 L
Drain valve Valvola di scarico	1"½ BSPP			
Cleaning criteria Avvio ciclo di pulizia	Differential pressure (0.6 bar), time intervals and manual operation Pressione differenziale (0.6 bar), intervalli di tempo, manualmente			

### Electrical data - Dati elettrici

Supply voltage Tensione di alimentazione	230 Vac 1-phase 50/60 Hz Optional: 400 Vac 3-phases 50/60 Hz
Control voltage Vtaggio di comando	24 Vdc
Electric motor power Potenza elettrica motore	75 W
Electric motor consumption Consumo motore elettrico	4,8 A

# ABR Filters

## Materials - Materiali

Filter Body Corpo filtro	AISI 304 / AISI 316
Cover Coperchio	AISI 304 / AISI 316
Screen support Supporto rete	AISI 304 / AISI 316
Gasket Guarnizioni	EPDM

## Head loss - Perdite di carico

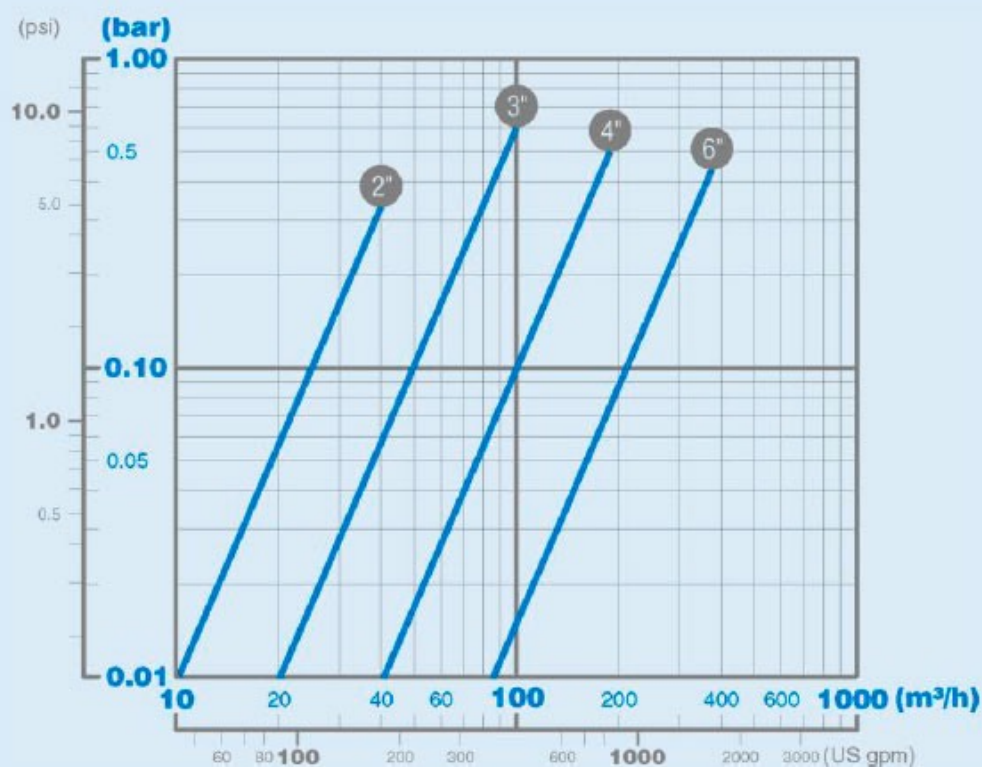

## DIMENSIONS - DIMENSIONI

Shape Y - Forma Y

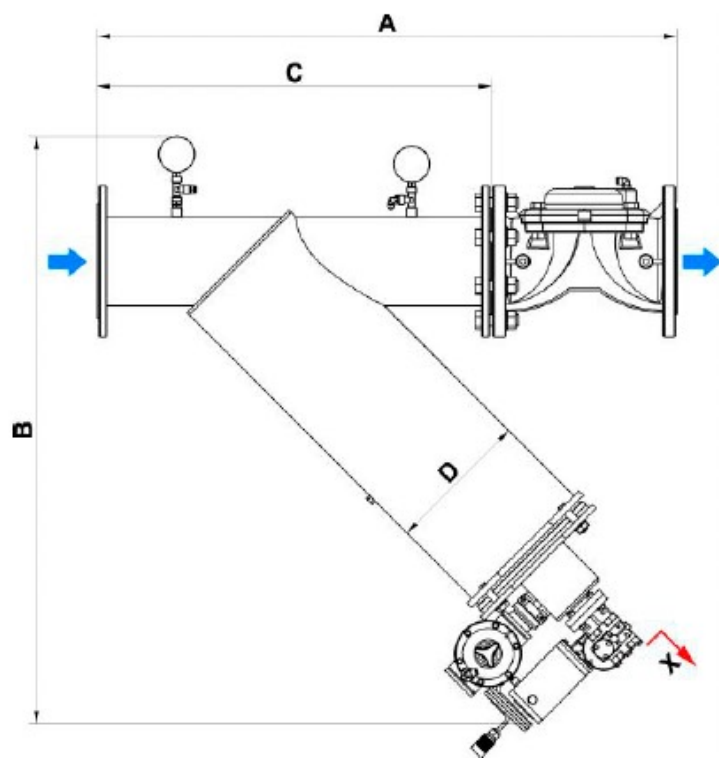

Filter Model <i>Modello filtro</i>	In/Out Conn.	Drain Conn.	Filter Area [cm <sup>2</sup> ]	Max Flow rate [m <sup>3</sup> /h]	A [mm]	B [mm]	C [mm]	D [mm]	X [mm]	Weight [Kg]
<b>ABR 16Y2</b>	2" flg	1"½ thrdF	1600	30	550	745	395	206	400	38
<b>ABR 16Y3</b>	3" flg	1"½ thrdF	1600	60	650	765	450	206	400	50
<b>ABR 16Y4</b>	4" flg	1"½ thrdF	1600	100	850	775	550	206	400	53
<b>ABR 23Y3</b>	3" flg	1"½ thrdF	2300	60	650	875	450	206	600	51
<b>ABR 23Y4</b>	4" flg	1"½ thrdF	2300	100	850	885	550	206	600	56
<b>ABR 35Y4</b>	4" flg	1"½ thrdF	3500	100	900	895	600	273	600	65
<b>ABR 35Y6</b>	6" flg	1"½ thrdF	3500	220	1100	925	745	273	600	93
<b>ABR 55Y4</b>	4" flg	1"½ thrdF	5500	100	900	1095	600	273	900	73
<b>ABR 55Y6</b>	6" flg	1"½ thrdF	5500	220	1100	1125	745	273	900	103



# ABR Filters

